

→ GENERAL INFORMATION

■ Registration

All registration on site will be invoiced. You will need to fill in a registration form, and you could pay directly online, or later, with the invoice.

■ Badges

Badges must be worn within the Conference area, both during the sessions and receptions.

In case of lost, the reprinting of the badge will be charged at 15 euros. It will also be asked for proof of identity.

■ Conference languages

The language of the sessions will be English and will be translated in Russian.

■ Meals

The lunches will be in the restaurant “La Grande Formule”, in La Villette, Floor -2.

The Conference dinner of Wednesday offered by Gasunie will be in “La Grande Formule”, in La Villette, Floor -2.

The Gala dinner of Thursday offered by GDF SUEZ will be in “Explora”, in La Villette, Floor 1. *Dress code: business attire*

■ La Cité des Sciences de la Villette

In the heart of the Cité des Sciences et de l'Industrie, the La Villette Conference Centre is part of a unique technological, scientific and cultural area in Paris. You can visit permanent exhibitions (Mathematics, Sounds, Humans and genes, Images, Space, The Nautilus, Automobile, Aeronautics, Energy, Rocks and volcanoes, Stars and galaxies, Tricks of light) and temporary exhibitions. Information of La Villette: Floor 0.

La Cité des Sciences is composed of different floors:

- ▶ Floor 0: Entrance
- ▶ Floor 1: Explora
- ▶ Floor 2: Explora level 2 (La Mezzanine)
- ▶ Floor -1: Conference center
- ▶ Floor -2: Restaurants “La Grande Formule” and “Le Hublot”

The Conference center (Floor -1) is composed of 3 levels (see Conference center plans, p. 20 to 25):

- ▶ Level S1
- ▶ Level S2
- ▶ Level S3

→ INNOVATION EXHIBIT

For the 1st time the International Gas Research Conference (IGRC2008) presents a novel 'Innovation Exhibit' with the aim of encouraging business leaders, industry engineers, practitioners, scientists and managers get 'hands on' with the latest cutting edge technologies crucial to the future of the gas industry.

The Innovation Exhibit is designed to disseminate the very latest technologies, from across the world, to the international natural gas community and to our customers.

The Innovation Exhibit provides a forum for companies to showcase the latest technologies and for demonstration and discussion with engineers, managers and potential users from the gas industry at what is, without doubt, the world's foremost gas research & technology conference.

You will find :

Compagny	Country	Technology	Number on plan / Level
Advantica	UK	GasPT - Gas Properties Transmitter	15 / Level S3
		Grouted Tee	16 / Level S3
AES Ltd	UK	External pipe condition assessment tool	17 / Level S3
ARELCO	France	New appliances and system for Wobbe Index measuring and regulating in industry	18 / Level S3
Banides et Debeaurain & GDF SUEZ	France	Excess flow valve (especially for existing gaz connection) "Stop gas flow protecting" for a gas pressure between 400 mbars and 4 bars	19 / Level S3
Beasy	UK	POF software	1 / Level S2
		CP module software	
Chuchu Decayeux	France	VIGIGAZ Gas circuit breaker	38 / Level S3
Crowcon Detection Instruments Ltd representation of a japanese company	Japan	GMethane detection at distance (LMD)	2 / Level S2

Compagny	Country	Technology	Number on plan / Level
Cybernetix	France	Monitoring survey device for steel pipes hits and leakages through acoustic wave analysis. (PIPELIDS system)	30 / Level S3
DBI-GUT	Germany	Inline sensor tool	20 / Level S3
Disenco	UK	Micro CHP system	21 / Level S3
E.ON-Ruhrgas	Germany	CHARM - CH ₄ Airborne remote monitoring laser-based system for remote gas detection - Efficient and reliable pipeline monitoring system by helicopter	13-14 / Level S2
		Gas Camera Mobile imaging system for visualising methane plumes at distances between 0 m and at least 100m	
		GasCalc - Software for the calculation of physical natural gas properties	
		Gas quality measurement for natural gases and biogases - gas-lab Q1	
GasTerra bv	The Netherlands	Micro CHP with high efficiency condensing boiler	22 / Level S3
Génésis (a subsidiary of Technip)	France	The ALLS flexible for offshore LNG offloading	10 / Level S3
GTI	USA	Hand-held Accoustic Pipe Locator	26 / Level S3
GTT	France	LNG Carrier bi-oblique tank n°1	12 / Level S2
		The "pipe in pipe" a LNG offloading system for remote offshore terminals	

Compagny	Country	Technology	Number on plan / Level
Heath Consultants	USA	Advanced leak detection technology - remote methane leak detector (RMLD™)	3 / Level S2
		DP-IR - A New Look In Leak Survey	
IDS	Italy	New generation Georadar / New horizontal drilling machine with remote controlled drill head	24 / Level S3
Kamstrup b.v.	The Netherlands	Kamstrup - Inspection system for gas stations	4 / Level S2
Kiwa	The Netherlands	PIRATE: autonomous robotic gas distribution pipeline inspection system	32 / Level S3
		IRENE Web-based; web service for gas network calculations and analyses	
Logica	The Netherlands	PicoSmart: Pipeline Inspecting Collaborative Swarms for Maintenance And Repair Tasks	27 / Level S3
Matsushita Electric Industrial Co.,Ltd	Japan	Ultrasonic gas meter	28 / Level S3
MBW Ltd	UK	The Soil Pick and stand	36 / Level S3
		MBW Soil Compaction Supervisor	
		MBW Soil Vac	
		MBW Ergo Tamper	
MTT bv	The Netherlands	MTT turbine : a novel micro gas turbine suited for micro CHP applications	29 / Level S3
Osys	UK	Resilient and Persistent Communications Systems	5 / Level S2

Compagny	Country	Technology	Number on plan / Level
Plug Power Inc	USA	Residential fuel cell system	35 / Level S3
Pure Technologies Group	Canada	SmartBall™ Acoustic Pipeline Leak Detection System	6 / Level S2
Sauron	France	New repair sleeve coming for gouges and suspect joints in PE pipes joined by fusion	37 / Level S3
Schlumberger	UK	Surveillance solutions	7 / Level S2
Stony Brook University (US)	USA	Energy harvesting wireless sensor system	34 / Level S3
Technip	France	High performance propane evaporators and condensers for LNG pre-cooling service using dual enhanced tubes	11 / Level S2
		Semi-submersible Hull for floating LNG	
		Utilization of Air Tower (reverse acting Cooling tower) for LNG vaporization	
Tokyo Gas Engineering Co, Ltd	Japan	New Gas adsorption system for recovery of remaining gas in gas-related equipment	33 / Level S3
Tracto Technik	Germany	Rock drill : Partial automatisisation in trenchless pipe installations by HDD	25 / Level S3
ULC Robotics	USA	Cisbot - Cast Iron Joint Sealing Robot	31 / Level S3
Utilicor	Canada	Coring and Reinstatement: "A Core Strategy for Environmentally Friendly Utility Cut Repairs"	23 / Level S3
Vaperma inc.	Canada	Methane Recapture and Elimination of VOC and GHG Emissions for Natural Gas Glycol Dehydrators	8 / Level S2
Yamatake Europe NV	Japan	Advanced gas mass flow sensor by Micro flow chip technology. Small and high speed Gas chromatography	9 / Level S2

TUESDAY 7 OCTOBER 2008

16:00 ► 20:00

Registration (every conference day from 08:00)**AMPHITHEATER GASTON BERGER**

Level S2

**WEDNESDAY
8 OCTOBER 2008****Keynote speeches and Oral presentations**

09:00 ► 10:50

Opening Plenary Session

- Speeches: **Daniel Paccoud**, **George Verberg** and **Jean-François Cirelli**
- Keynote speaker: **Vlada V. Rusakova**
- **CEOs' roundtable**

10:50 ► 11:15

11:15 ► 12:45

- A** R&D - is technology key to the changing gas market?

12:45 ► 14:00

14:00 ► 17:00

17:00 ► 19:00

- B** Next generation appliances - is there a gap between marketing and technology?

19:00 ► 22:30

**THURSDAY
9 OCTOBER 2008**

08:30 ► 12:30

12:30 ► 14:00

14:00 ► 16:00

- G** Residential market – is there a future for natural gas

16:00 ► 18:30

Workshop
16:30-18:30 CO₂ Capture and Storage

18:30 ► 19:00

Keynote speaker: **Nobuo Tanaka**

19:00 ► 22:30

**FRIDAY
10 OCTOBER 2008**

09:00 ► 11:00

- H** Climate change - what can the gas industry offer?

11:00 ► 11:30

11:30 ► 13:00

Closing Plenary Session

- Speech: **George Verberg**
- Keynote speaker: **Olivier Appert**
- Speaker: **Christian Beckervordersandforth** (and Dan Dolenc prize)
- Presentation of IGRC 2011 and closure

Note: The sessions will be held in English and translated into Russian.

ROOM
LOUIS ARMAND
West / Level S3

ROOM
LOUIS ARMAND
East / Level S3

LOBBY

Oral presentations and workshops

Innovation Exhibit and Poster sessions

		Coffee - Break
C LNG - What comes next?	D Underground storage technology - how to use it in the new era?	
		<i>Lunch*</i>
	Workshop: Pipeline Integrity	Poster session Innovation exhibit Coffee - break
E Pipeline integrity - what are the new challenges for asset management?	F Gas quality - how to balance conflicting issues?	
		Conference Dinner Gasunie*, Speech Marcel Kramer

	Workshop 08:30-10:00 Biogases 10:00-12:30 Hydrogen	Poster session Innovation exhibit Coffee - break
		<i>Lunch*</i>
K E&P: Fit for the future ?	I Sustainable energy - is natural gas the bridge to sustainability?	
		Poster session Innovation exhibit Coffee - break
		Gala Dinner Sponsored by GDF SUEZ**

L Gas and electricity networks - what are the options for intelligent energy management?	M Next generation of gas transmission and distribution - what is it?	
		Coffee - Break

→ CONFERENCE CENTER PLANS LEVEL S1

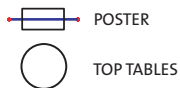
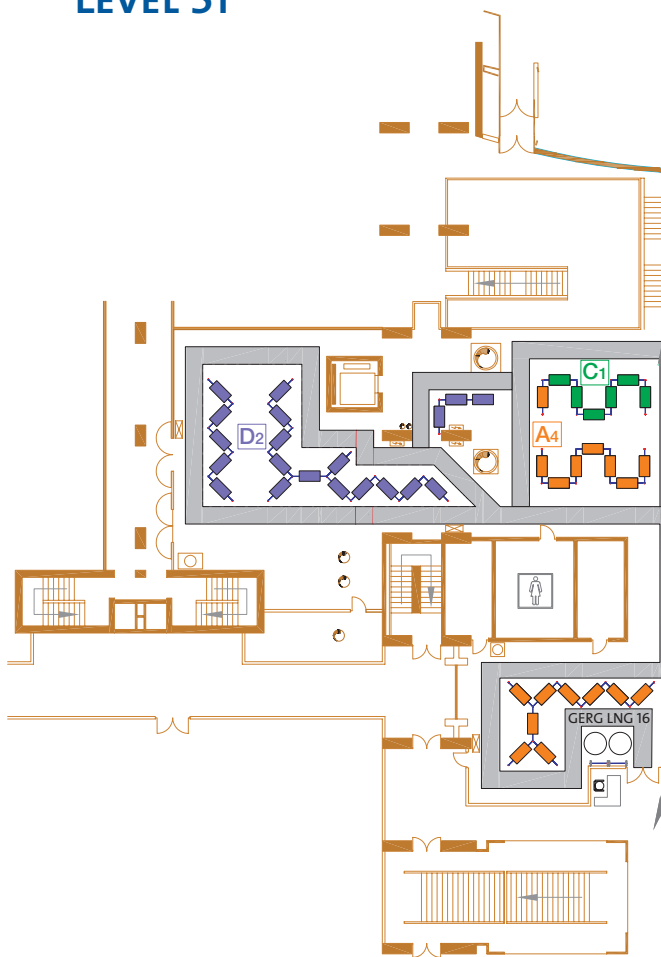

RECEPTIONS

→ Implementation map S1

FLOOR 0

FLOOR -1

LEVEL S1

LEVEL S2

LEVEL S3

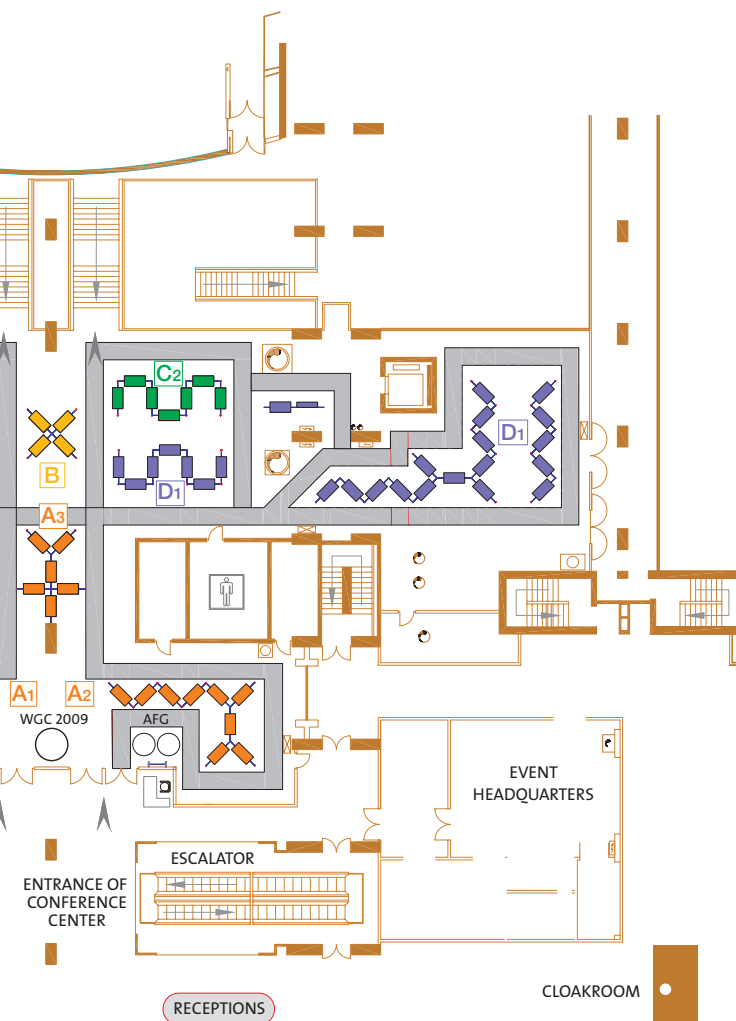

Category and Color code	Area	Posters numbering
Sustainable Development	C1 / C2	no. 73 to 98
Transmission	A1 / A2 / A3 / A4	no. 1 to 64
Storage	B	no. 65 to 72
Utilisation	D1 / D2	no. 99 to 189

→ CONFERENCE CENTER PLANS LEVEL S2

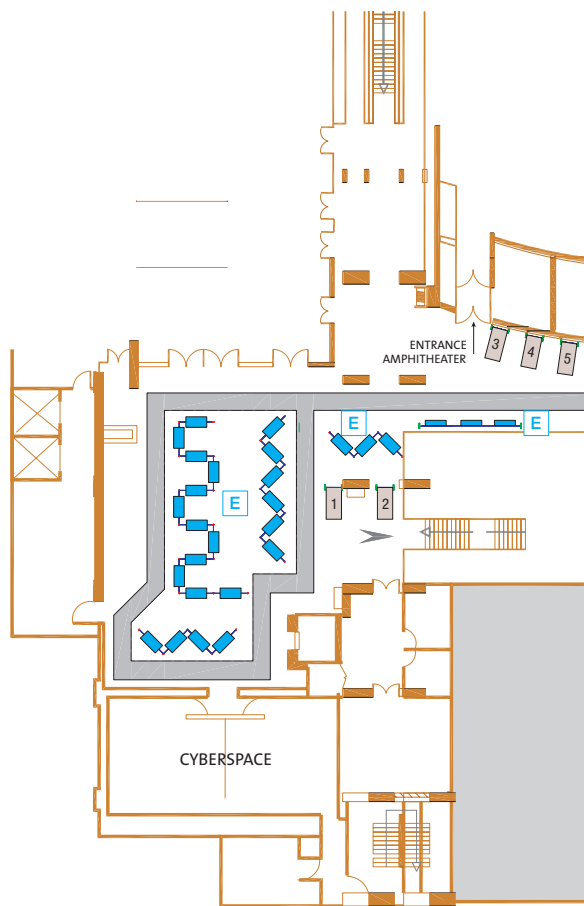

POSTER

INNOVATION EXHIBIT (LIST OF EXHIBITORS P. 68)

→ **Implantation map S2**

FLOOR 0

FLOOR -1

LEVEL S1

LEVEL S2

LEVEL S3

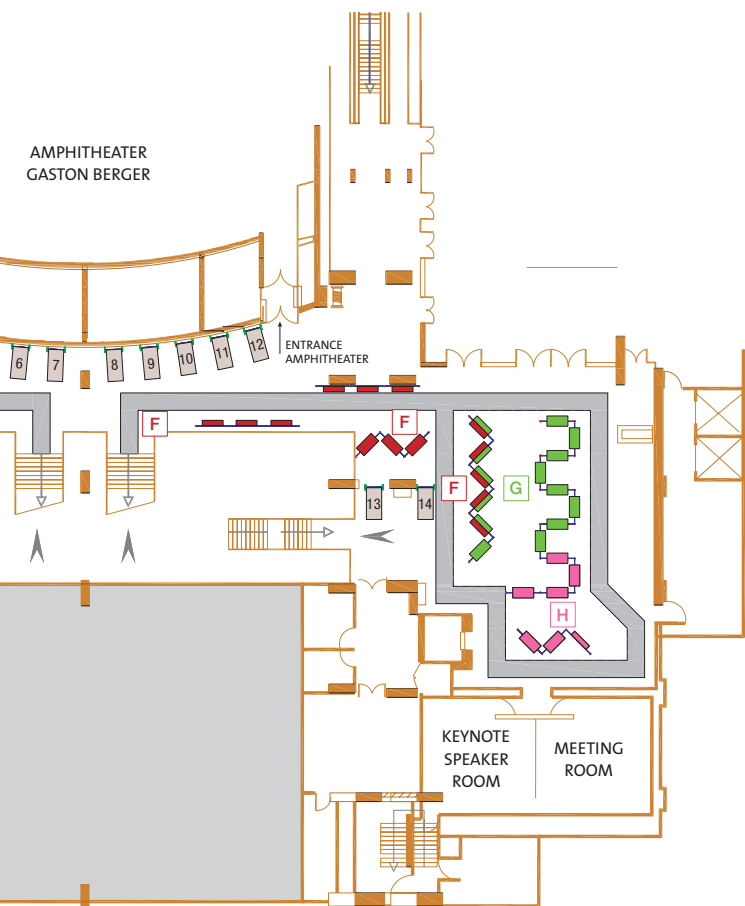

Category and Color code	Area	Posters numbering
Distribution	E	no. 190 to 241
Exploration & production	G	no. 260 to 282
LNG	F	no. 242 to 259
Strategy & regulation	H	no. 283 to 295

→ CONFERENCE CENTER PLANS LEVEL S3

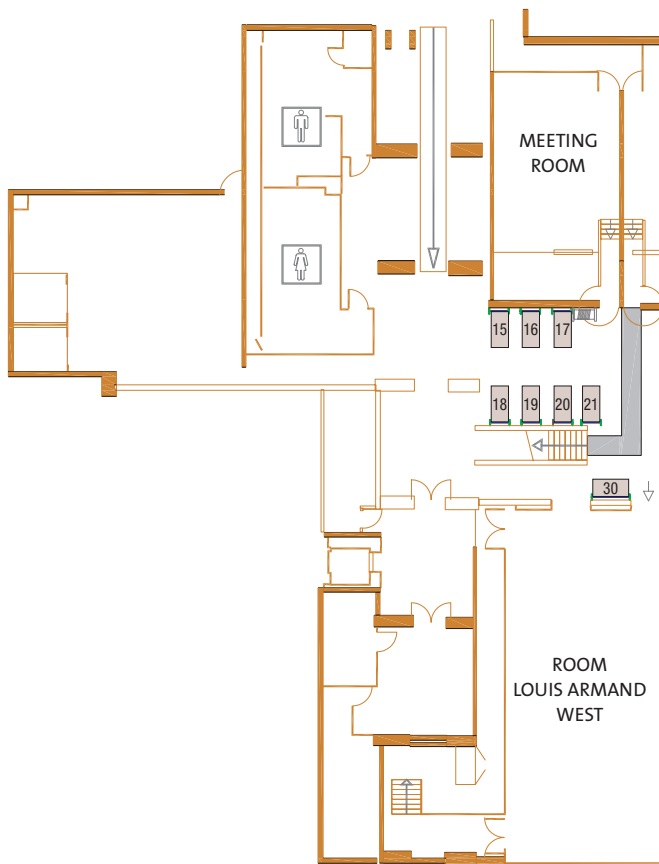

INNOVATION EXHIBIT (LIST OF EXHIBITORS P. 68)

→ **Implantation map S3**

FLOOR 0

FLOOR -1

LEVEL S1

LEVEL S2

LEVEL S3

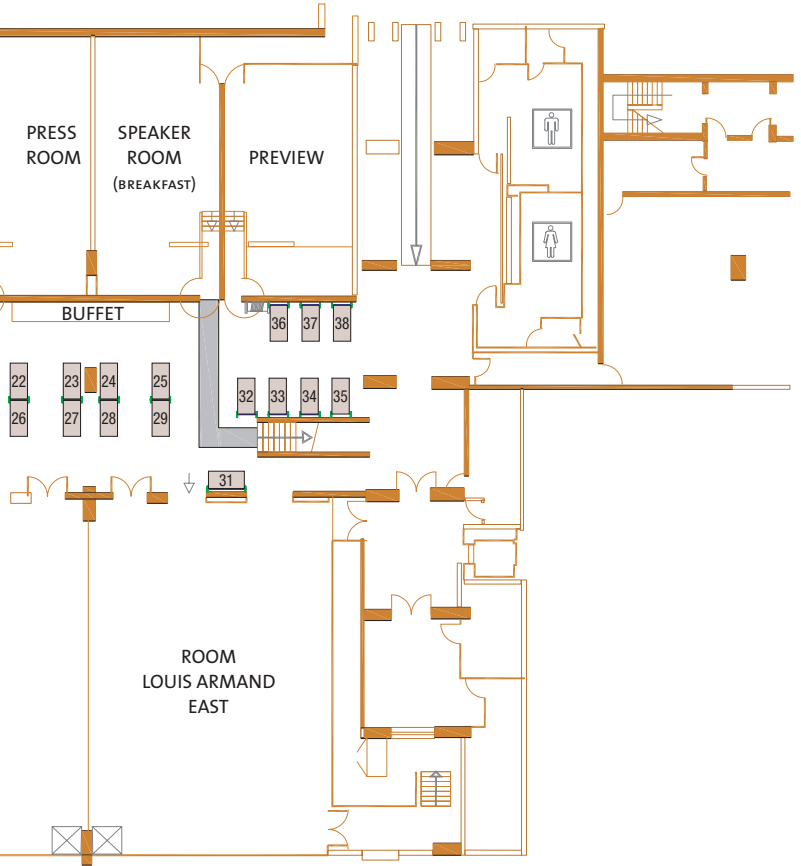

→ LA CITÉ DES SCIENCES ET DE L'INDUSTRIE - LA VILLETTE

VENUE AND ACCOMMODATION

The IGRC 2008 will take place in La Cité des Sciences et de l'Industrie, 30, avenue Corentin-Cariou, 75019 Paris.

■ How to reach the La Villette Center?

► BY CAR

Northern Paris ring road (périphérique nord), exit "Porte de la Villette".

- Fee-paying car park, entrances on Quai de la Charente and Boulevard Macdonald. Open every day, 24/7.
- 1600 underground places with direct access to the heart of the Cité. Delegates are offered a special rate.

For more information please call 33 (0) 1 40 05 79 90

► BY METRO

Line 7, direction La Courneuve - 8 mai 1945, *Porte de la Villette* station (20 min. from the Opéra and famous Parisian stores).

Prepare your itinerary with RATP: www.ratp.fr

► BY BUS

PC1, 2 et 3, Bus 75, 139, 150, 152, 249 and Noctambus N42. Stop: *Porte de la Villette*.

Prepare your itinerary with RATP: www.ratp.fr

► BY TRAIN

- Gare du Nord (Eurostar and Thalys): 15 minutes by metro.
- Gare de l'Est: 10 minutes by metro.
- Gare Saint-Lazare: 30 minutes by metro.
- Gare Montparnasse: 30 minutes by metro.
- Gare de Lyon: 40 minutes by metro.

Prepare your itinerary with RATP: www.ratp.fr

Prepare your rail itinerary with SNCF: www.voyages-sncf.com

► BY PLANE

Airports of Orly and Roissy Charles-de-Gaulle: 30 minutes by car. *More information about Paris Airports: www.aeroportsdeparis.fr*

Prepare your journey with our Transport Partnership Air France:



- Identifier Code: 04117AF

Valid for travel from 03/10/2008 to 15/10/2008

Discounts are applied to a wide range of airfares, in all classes of travel (Espace Première [First], Espace Affaires [Business] and Tempo [Coach] on all Air France flights worldwide).

To access the preferential fares granted for this event, use this link: www.airfrance-globalmeetings.com or the website of this event.

This present document of the event serves to justify the application of the preferential airfare. Keep it with you as you may be asked for it at any point of your journey.

To locate your nearest Air France sales point, consult:

www.airfrance.com

MAP

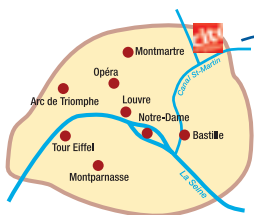

Hotels in Paris

► Hotel Forest Hill La Villette

28ter avenue Corentin Cariou - 75019 Paris

Tel: +33.1.44.72.15.30

Metro: Line 7, station *La Villette*

Situation: 10 minutes walking distance to Cité des Sciences

► Hotel Ibis Paris La Villette

31-35 quai de l'Oise - 75019 Paris

Tel: +33.1.40.38.58.01

Metro: Line 7, direction La Courneuve - 8 mai 1945, station *Porte de la Villette*

Bus: PC1, 2 et 3, Bus 75, 139, 150, 152, 249 and Noctambus N42 / Stop: *Porte de la Villette*

Situation: 10 minutes walking distance to Cité des Sciences

► Hotel Express by Holiday Inn-Canal de la Villette

68 quai de la Seine - 75019 Paris

Tel: +33.1.30.08.18.09

Metro: Line 7, station *Crimée* or Line 5, station *Laumière*

Buses: Lines 54 and 60, station *Crimée*

Situation: 12 minutes walking distance or 5 minutes by metro to Cité des Sciences

► Hotel Ibis Paris Gare du Nord

197-199, rue Lafayette - 75010 Paris

Tel: +33.1.44.65.70.00

Metro: Line 7, station *Louis Blanc*

Situation: 15 minutes by metro to Cité des Sciences

► Hotel Ibis Gare de l'Est

6 rue Saint Laurent - 75010 Paris

Tel: +33.1.40.38.05.05

Metro: Line 7, station *Gare de l'Est (Verdun)*

Situation: 20 minutes by metro to Cité des Sciences

► Hotel Ibis Paris Berthier Porte de Clichy

163bis avenue de Clichy - 75017 Paris

Tel: +33.1.40.25.20.00

Metro: Line 13, station *Brochant*

RER: Line C, station *Porte de Clichy*

Buses: 31, 66, 54

Situation: 30 minutes by metro to Cité des Sciences